

mec
switches

Foilmec™

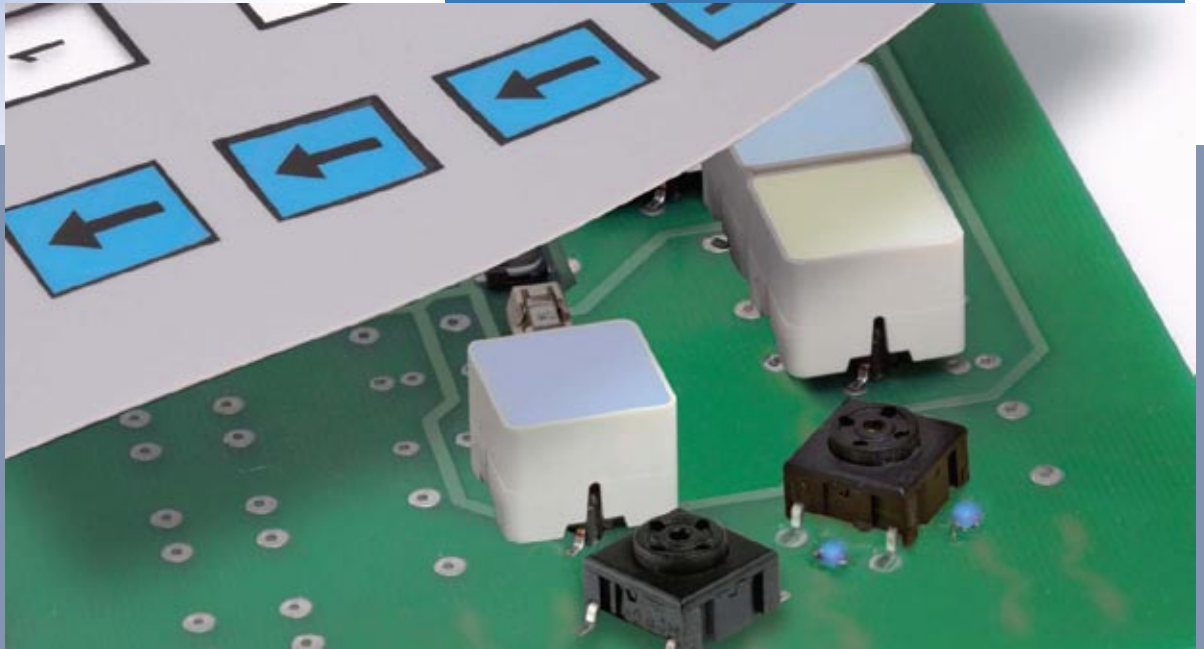

Foilmec™ is optimized for use with foil overlays and offers a fully illuminated solution by means of 4 LED's placed directly on the PCB.

The LED illumination can be either SMT or through-hole and provides a choice of colors.

Foilmec™ is the ideal solution for cost effective assembly of an overlay with discrete switches and LED illumination to produce back lighted keypads.

The basic 3E switch used for Foilmec™ is rugged and reliable with a mechanical life exceeding 10,000,000 cycles and sealing to IP67.



Sorenson Lighted Controls
Illuminating Innovation™

Foilmec™

Technical Data:

- Through-hole or SMD
- 50mA/24VDC
- Single pole/momentary
- 10.000.000 operations life time
- IP67 sealing
- Temperature range:
Std. temp: -40/+115°C
High temp: -40/+160°C
Keycap: -30/+85°C

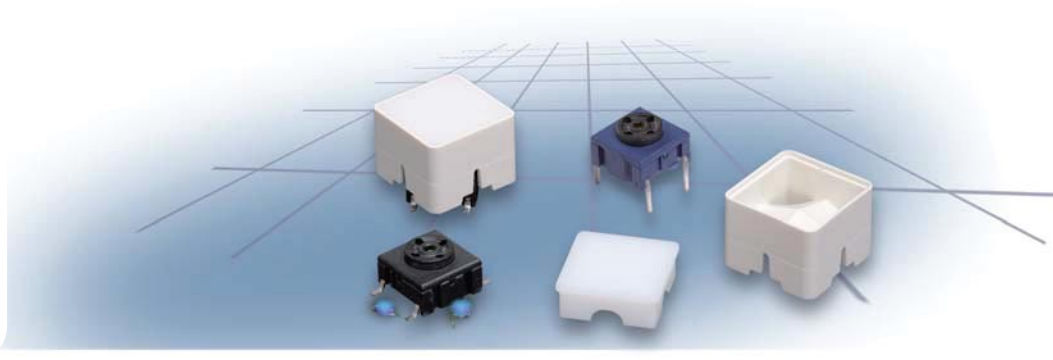

Dimensions (through-hole)

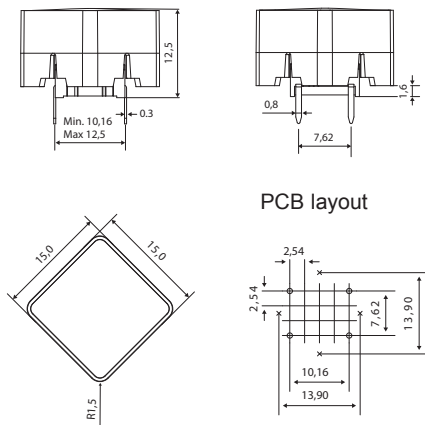

Dimensions (SMD)

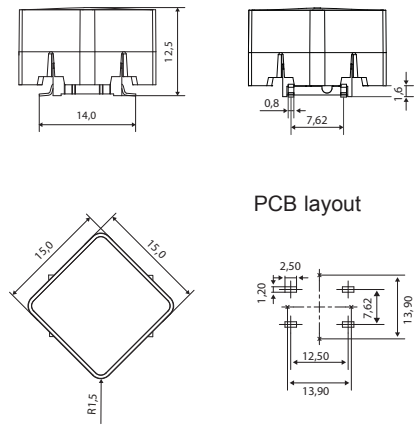

Recommended placement of LEDs

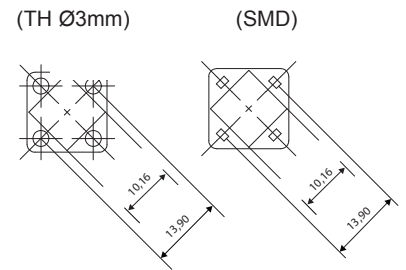

LED Recommendation
 SMD: 1206 - 0805 - 0603 - 0402
 TH: 3 mm - Ø max. 3,2 - Height Max. 6,5 mm
 Wide spread angle versions recommended

How to order

| | | | | | | | | | | |
|---------------|------------------------|--|--|---|--------------------|----------|----------|----------|----------|----------|
| 3 | E | | | + | 1 | Y | 0 | 6 | 1 | 6 |
| Switch | Mounting | | | | Cap - white | | | | | |
| | T through-hole | | | | | | | | | |
| | S surface mount | | | | | | | | | |
| | | | | | | | | | | |
| | | | | | | | | | | |

Ordering example: 3ESH9 + 1Y0616

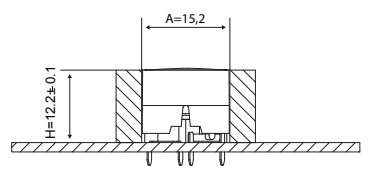
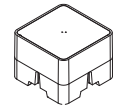

A: We recommend you to allocate enough space for travel of the foil and leave the area free from adhesive. Switch travel = 1 mm.
 H: We recommend embossing the foil to follow the curve of the keycap.
 The best tactile feeling is obtained by a small pretravel of typically 0.2 mm.
 The dimension H is based on a flat foil. With an embossed foil the dimension will have to be adjusted.

Dimensions (mm) Unless otherwise specified, all tolerances ± 0,2

For updates of products and/or changes of specifications see www.solico.com