

# 31

- Snap fits into 0.50" panel hole
- Body and lens are one piece design
- LED, incandescent, and neon illumination
- Splashproof

### SPECIFICATIONS

Body Material:	Polycarbonate	Wire Strip:	1/2"
Lens Material:	Polycarbonate	Panel Thickness:	0.040" to 0.110"
Wire Gauge:	20 ga.	Certifications:	See Page 1



### 31 with 57 lens

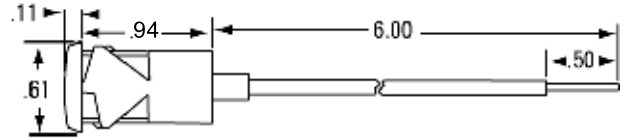

### 31 with 59 lens

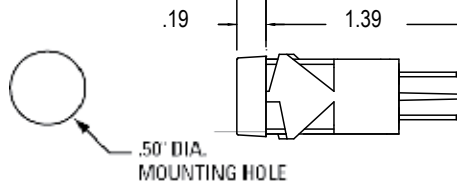

Series	Lamp			Termination		Base		Bezel		Lens				
XX	XX			X		X		X		XXX			X 0	
31	Voltage	Type	Code	Style	Code	Color	Code	Finish	Code	Style	Code	Color	Code	
	2	LED	10	6" Wire	1	N/A	0	None	0	Semi-Dome Rings	576	Red	1	
	6	LED	11	.187 Tabs	3			Chrome <sup>2</sup>	1	Semi-Dome Rings w/ Bezel	586	Amber	2	
	14	LED	12	.250 Tabs	4					Cylinder Rings	596	Clear <sup>1</sup>	3	
	28	LED	13	Special	X							Green	4	
												Blue	5	
	6	INCAND	32											
	14	INCAND	35											
	28	INCAND	39											
	125	NEON	50											
	250	NEON	52											
		Special	XX											

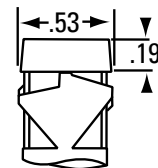

Lens 59

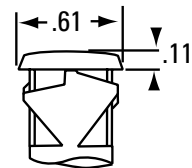

Lens 57 & 58

### ADDITIONAL OPTIONS AVAILABLE:

Contact Factory

1. Specify LED Color if applicable
2. Available with lens 58 only